

**NOTES:**

1. ALL DIMENSIONS ARE IN MILLIMETRES UNLESS OTHERWISE NOTED.
2. HYDRANT NOZZLES TO BE PLACED FACING CURB.
3. BRANCH LINE TO BE LAID HORIZONTALLY.
4. REFER TO P.U.C. SPECS FOR APPROVED RESTRAINED JOINT PRODUCTS.
5. WHEN USING MECHANICAL JOINT RESTRAINTS, THE WATERMAIN JOINTS SHALL ALSO BE RESTRAINED 2 JOINTS (OR EQUIVILANT OF 2 FULL PIPE LENGTHS) EACH SIDE OF TEE.
6. IF A HYDRANT EXTENSION IS REQUIRED IT SHALL BE PLACED ON THE BOTTOM OF THE HYDRANT AT THE TIME OF INITIAL INSTALLATION.
7. A 20mm CRUSHED STONE DRAINAGE PIT SHALL BE USED WHERE EXISTING SOIL IS IMPERVIOUS, SUCH AS CLAY.
8. NO DRAINAGE PIT IS REQUIRED WHERE SOIL IS SAND OR GRAVEL.
9. VALVE BOX TO BE ADEQUATELY BRACED DURING BACKFILLING AND MUST REMAIN VERTICAL.
10. POLYETHYLENE BOND BREAKER TO BE USED BETWEEN CONCRETE AND FITTINGS.
11. EACH HYDRANT, VALVE AND METALLIC TEE ON NON-METALLIC WATERMAIN TO HAVE ONE MAGNESIUM ANODE ATTACHED FOR CATHODIC PROTECTION AS PER AS PER SPECIFICATIONS AND DWG A2732.
12. ANCHOR TEE AND VALVE NOT TO BE USED IF VALVE LOCATION IS IN ROAD OR IN THE CURB LINE UNLESS AUTHORIZED BY ENGINEERING. (REFER TO PUC DWG A2729)

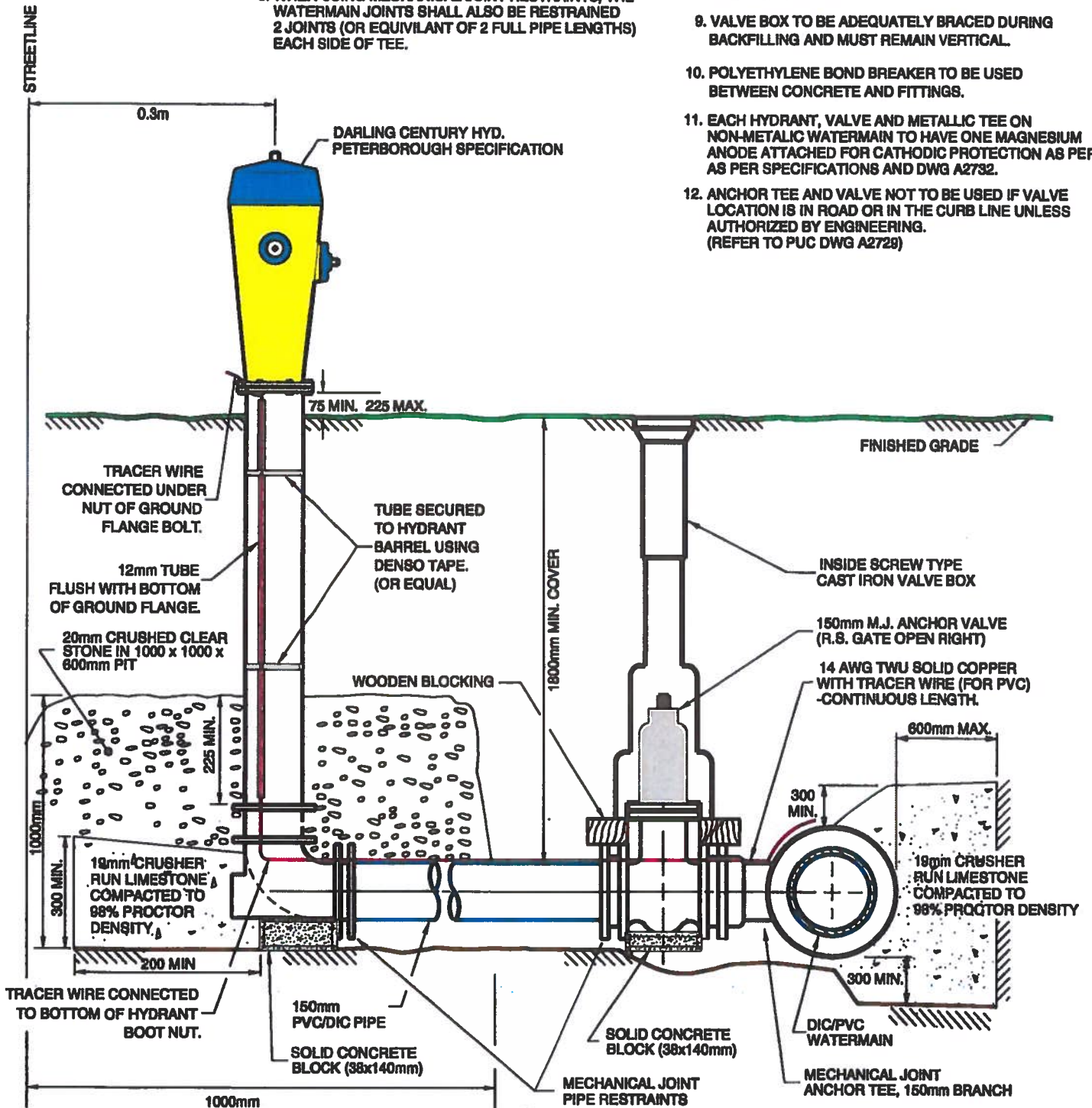

**PETERBOROUGH UTILITIES SERVICES INCORPORATED**

TITLE		No.	REVISION	DATE
STANDARD HYDRANT, ANCHOR TEE AND VALVE INSTALLATION WITH MECHANICAL RESTRAINED JOINTS		1.	REVISE NOTE 6	09 JAN 2014
DRAWN BY	Steve Billings	2.		
DESIGNED	<i>Steve Billings</i>	DRAWING No.		
APPROVED	<i>[Signature]</i>	CADD A2976		
SCALE	N.T.S.	DATE JANUARY 9, 2014		
JOB COST				